



Reference Manual
Manuel de reference

USA 855-2-CANOPY
USA WWW.EURMAX.COM



Caution!

Please read this before proceeding. As a new Eurmax Canopy User, it's your responsibility to be fully aware of the following warnings.

- The frame **MUST-BE-STAKED** or properly weighted down at all times.
- Use extreme caution, even in light wind conditions!
Takedown in wind speed of 10 MPH or greater.
- **Never** leave your shelter unattended! Wind and rain can cause damage to frame and or possibly result in serious injury to you or others.
- Your Eurmax Canopy is a temporary pop-up shelter, we do not recommend leaving the canopy open for an extended period of frame.
- Keep all flame and heat sources well away from the fabric top. **DO NOT** build fires within the shelter.

What's Included: Frame + Top + Wall kit + Wheeled Bag + 4 x Spikes + 4 x Ropes + Spare Bolts & Nuts



Setup | Installation | Instalacion

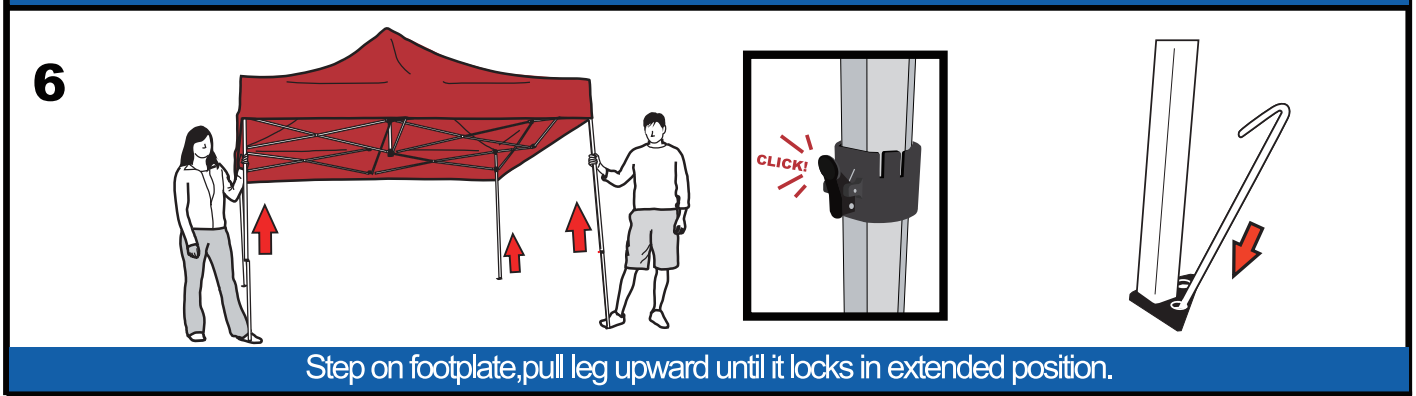
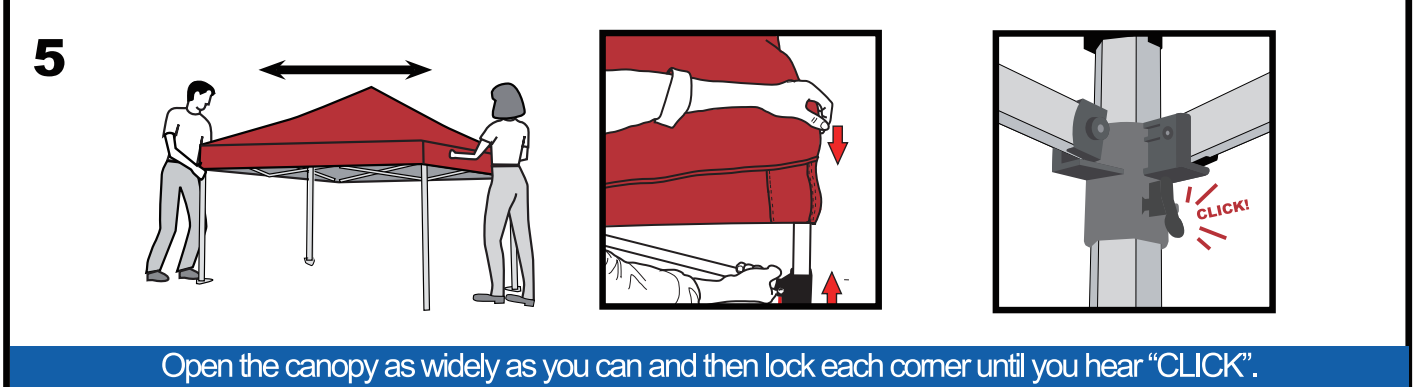
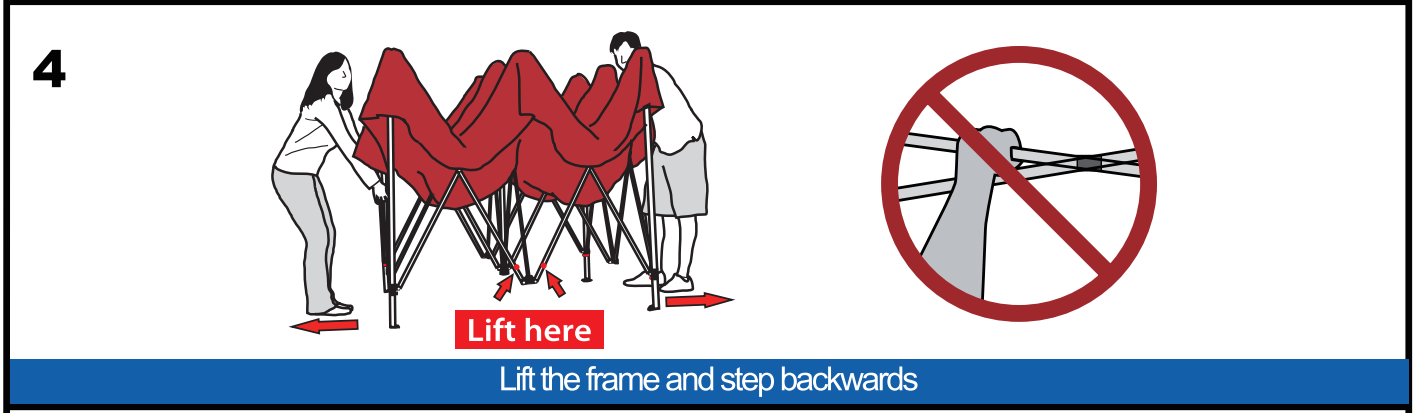
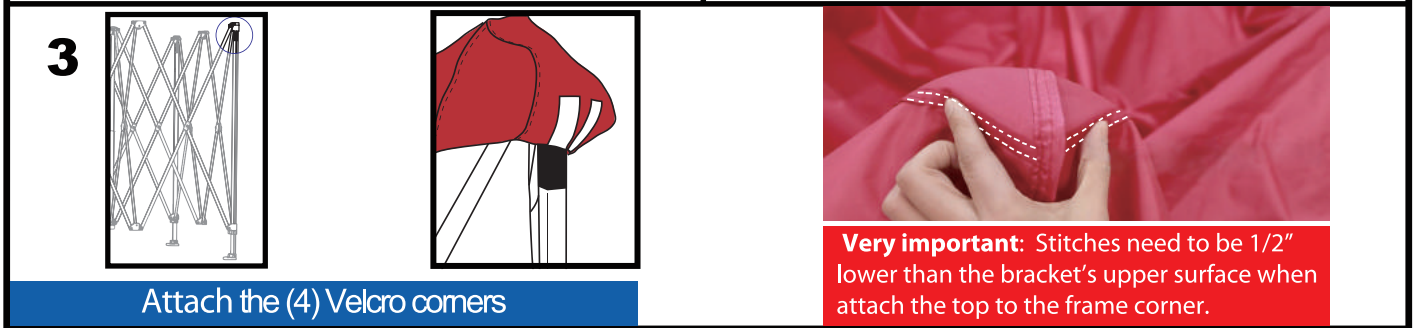
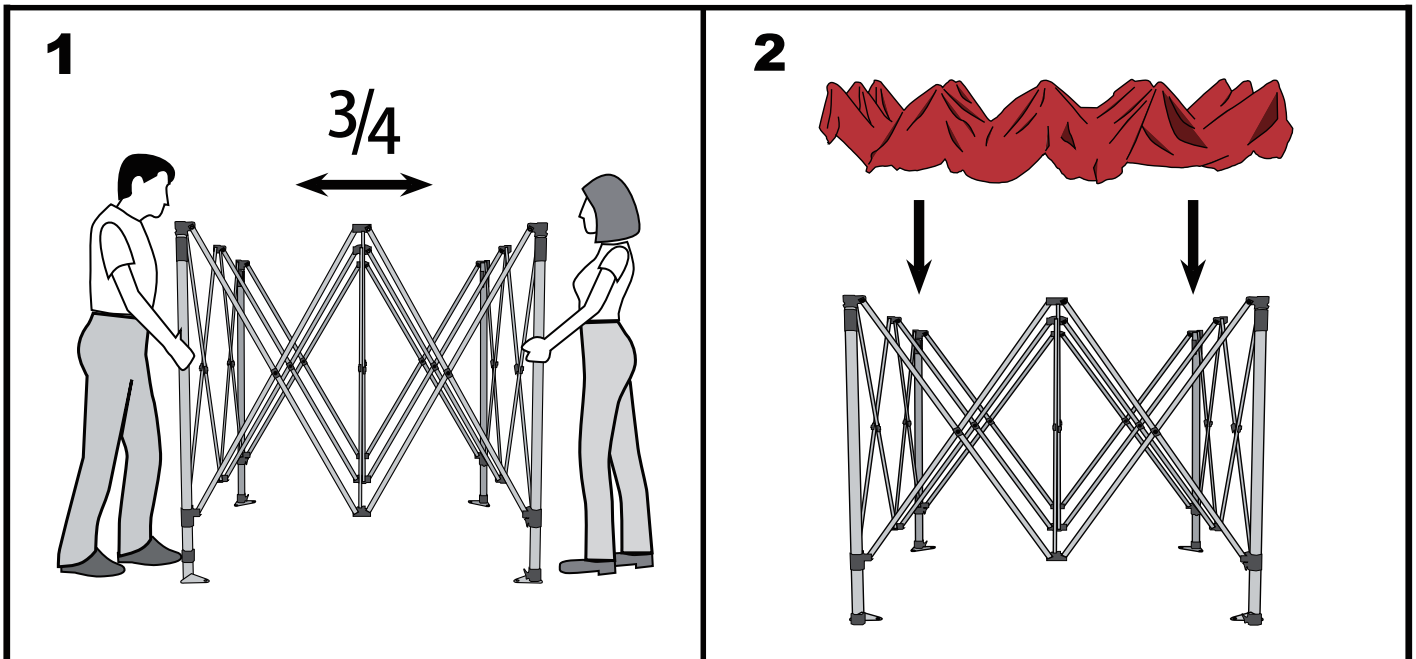

How to use your wheeled bag

You can leave the top on frame for short period storage. If you are not going to use the canopy for long time, it is recommended that the top to be removed from the frame and storage separately to avoid fabric wrinkle.



1



2



3



4



5

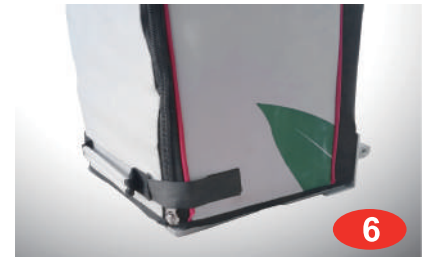

6



7

Slide metal plate underneath foot pad leg.

Tighten velcro strap firmly.

Replacement parts | Pièces de rechange

Order your replacement parts online, visit our website for more information.

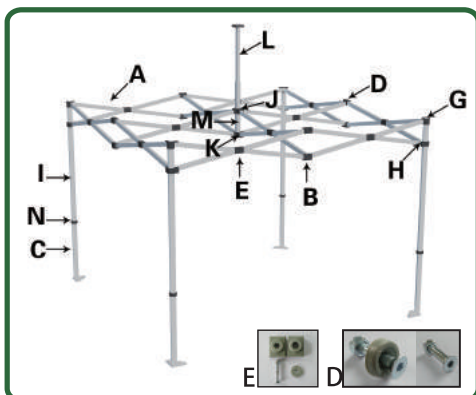

A	TRUSS BAR	I	OUTER LEG WITH VELCRO
B	TRUSS CAP - LOW or UPPER	J	UPPER PEAK BRACKET
C	INNER LEG WITH FOOT PAD	K	LOWER PEAK BRACKET
D	JOINT BOLT&NUT	L	PEAK POLE WITH DOME CAP
E	JOINT BOLT/WASHER/CAP	M	PEAK POLE LOWER
G	CORNER LEG CAP	N	HEIGHT ADJUSTER
H	CORNER LEG SLIDER		

Basic/Std/Premium/Pro/Beyond

Safety Precautions And Care Instructions | E Instrucciones De Cuidado

- Do not use your canopy as a permanent shelter. It is designed for temporary use only. Damage due to weather conditions are not covered under warranty.
- Do not set up on a steep incline. Always set up on a level ground. Do not leave your canopy unattended. Always use tie-downs, stakes or weight feet to secure your EURMAX canopy especially in windy conditions.
- Never set up in windy, rainy, or snowy conditions. Do not let snow or rain accumulate on canopy top, this can result in damage or collapsing.
- Do not machine wash your canopy cover. Wash with mild soap and water with a brush while the instant canopy is open without the legs extended. Do not use harsh detergents, abrasives.
- Do not pack your canopy away damp or wet. This promotes mildew or rust. Always store completely dry.
- For best results in keeping your top clean and to avoid small rips and tears, it is recommended that the top be removed from frame and stored in the carry bag after each use.
- Ne pas utiliser votre abri comme un abri permanent. Il est prévu que pour utilisation provisoire!
- Ne pas monter sur les pentes raides et les plans inclinés. Ne jamais laisser sans supervision.
- Ne jamais monter l'abri dans les conditions météorologiques suivantes: pluie, vents fort ou la neige. Ne pas laisser l'eau ou la neige s'accumuler sur le toit.
- Utiliser les points de fixation au sol, des piquets ou des sacs de lestage pour bien fixer votre abri eurmax dans les conditions venteuses.
- Ne jamais nettoyer le toit de votre abri à la machine. Si un nettoyage est nécessaire, utiliser un détergent doux avec une brosse et nettoyer le toit quand il est tendu sur l'armature.
- Laisser le toit sécher complètement avant de le ranger.
- Pour garder votre toit propre et empêcher les petites déchirures, il est recommandé de retirer le toit de l'armature et de le ranger dans le sac après chaque utilisation.
- No utilice el toldo como una cubierta permanente ya que está diseñado solo para uso temporal. Los daños causados por las inclemencias del tiempo no están cubiertos por la garantía.
- No lo instale sobre terrenos empinados y no lo deje desatendido.
- Nunca lo instale cuando haga viento, cuando llueva o nieve. No permita que la lluvia o la nieve se acumulen en el toldo ya que este colapsaría.
- Utilice ataduras, estacas o pesas para asegurar el toldo en condiciones ventosas. Usted podrá comprar como accesorio adicional los kits comerciales de estacas y pesas que tiene a la venta eurmax canopies.
- No lave la carpa en lavadora. Lávela con jabón suave, agua y un cepillo mientras el toldo esté abierto pero con sus patas contraídas. No utilice detergentes fuertes, abrasivos ni blanqueadores.
- No guarde el toldo cuando esté mojado o húmedo. Esto promoverá el moho y la oxidación.
- Guárdelo siempre completamente seco. Para conservar mejor la carpa y evitar que se rasgue, se recomienda que la quite del toldo después de cada uso y que la guarde en la bolsa para transporte.

Eurmax Custom Canopy

Eurmax canopy offers high quality,digital and silk printing.Customizing can increase brand appeal for any company or organization.Simply email: USA: customgraphics@eurmax.com for a **free rendition & quote**.Or call us at 855-2-CANOPY.

Les Tentes Eurmax Personnalis **É** Es

Les tentes Eurmax peuvent être personnalisées selon vos propres spécifications. Affichez vos couleurs

avec un toit, des murs ou des jupes personnalisées. Eurmax Canopies Inc. possède et utilise les nouvelles technologies (l'impression par sublimation et par sérigraphie) qui nous permettent d'atteindre les plus hautes normes de reproduction d'image.

Email to USA: customgraphics@eurmax.com for a **free rendition"e**.

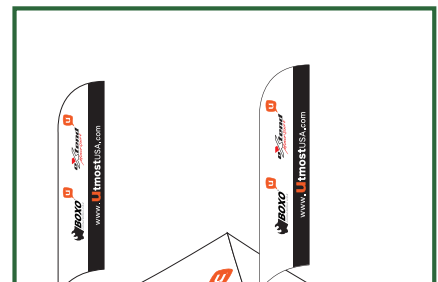
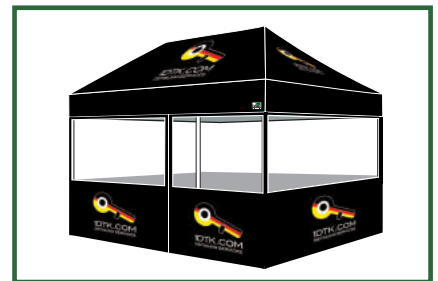
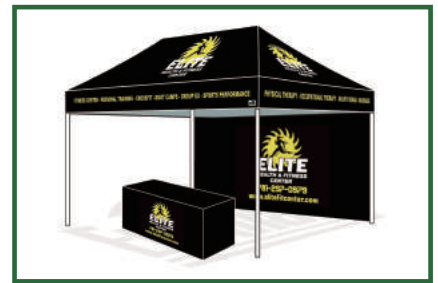

Manufactured and distributed by:
Fabrique et distribue par:
Fabricado y distribuido por



USA 626-279-1622
USA WWW.EURMAX.COM